

				SPECIFICATION				VDI 2198			
CHARACTERISTICS	1	Manufacturer			DIMEX LIFT						
	2	Manufacturer's designation			EP20M/H	EP30M/H	EP20MC/HC	EP30MC/HC			
	3	Power unit /Battery, Diesel, LPG/			Battery						
	4	Control type			Sit						
	5	Carried load capacity	Q	t	2,0	3,0	2,0	3,0			
	6	Wheelbase	y	mm	1660						
WEIGHT	7	Service weight /with battery/		kg	1400	1750	1510	1860			
	8	Axle load with load, front/rear		kg	1400/2000	1900/2850	1500/2010	2000/2860			
	9	Axle load without load, front/rear		kg	650/750	820/930	750/760	920/940			
SHASSIS	10	Tyres, front/rear (L - pneumatic, SE - superelastic)			L/L						
	11	Tyre size, front			23x5 PR10						
	12	Tyre size, rear			23x5 PR10						
	13	Wheels, number front/rear (x = driven)			2/2x						
	14	Tread, front	b ₁₀	mm	930						
	15	Tread, rear	b ₁₁	mm	1100						
DIMENSIONS	16	Height	h ₆	mm	1410		2250				
	17	Height of seat/stand-on platform	h ₇	mm	1050						
	18	Towing coupling height, minimum/maximum	h ₁₀	mm	810						
	19	Platform height, without load	h ₁₁	mm	860						
	20	Loading platform, length	l ₃	mm	2130						
	21	Rear overhang	l ₅	mm	720						
	22	Overall length	l ₁	mm	3370		3450				
	23	Overall width	b	mm	1300						
	24	Ground clearance	m ₁	mm	—	—	340	340			
	25	Ground clearance, centre of wheelbase	m ₂	mm	340	300	330	290			
	26	Turning radius	W _a	mm	2900		2975				
	27	Minimum pivoting point distance	b ₁₃	mm	800						
PERFORMANCE	28	Travel speed, with/without load		km/h	16/20						
	29	Drawbar pull, with/without carried load		N	800						
	30	Gradeability, with/without load		%	12/20	10/20	12/20	10/20			
	31	Service break			Hydraulic						
POWER TRAIN	32	Drive motor, output		kW	3,6 / 4,5 / 6,0 / 6,3						
	33	Steering motor, output		kW	0,7						
	34	Battery equipment to DIN 43531 /35/ 36/ A, B, C, no			43536 A						
	35	Battery voltage / capacity (C5)		V/Ah	80/165	80/300	80/165	80/300			
	36	Battery weight		kg	589	800	589	800			
	37	Type of drive control			Pulse control						
OTHER	38	Noise level at operator's seat		dB (A)	68						

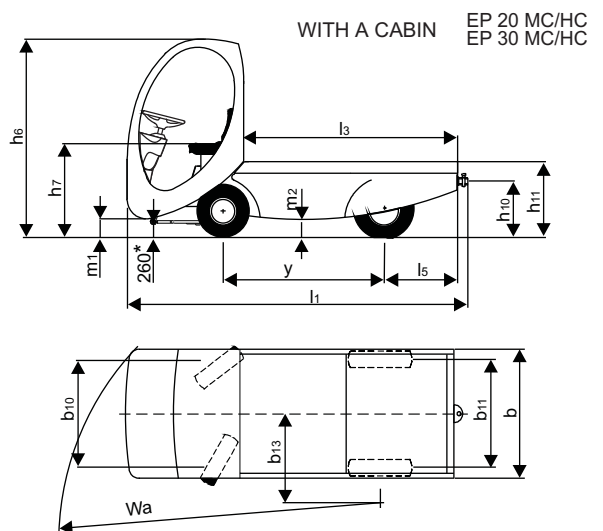
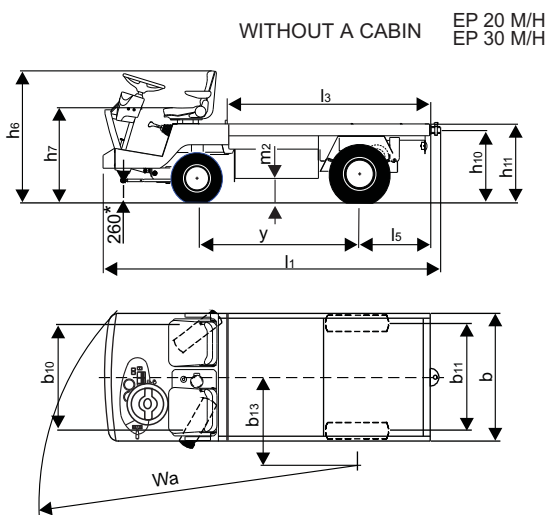

Note:

* - Dimension marked with * refers only to platform truck with mechanical steering.